

## Product overview

IG Masonry Support's Stainless Steel Shims are designed to be inserted between IG's Thermal Shim and IG's masonry support brackets to accommodate small changes in cavity widths. Shims are available in 3mm, 4mm, 5mm and 6mm thicknesses and are not supplied as standard with IG's masonry support systems.

Stainless Steel Shims are manufactured from either 304/304L Austenitic Stainless Steel (1.4301/1.4307) or 316/316L (1.4401/1.4404) on request.

### Enhanced features

- Stainless steel - A1 fire-rated material
- Suitable to facilitate small increases in cavity widths
- Available in various thicknesses: 3mm, 4mm, 5mm and 6mm
- Good dimensional accuracy
- Abrasion resistant

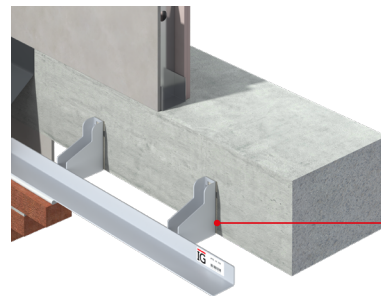

### Positioning the shims and brackets

Brackets must be installed at the correct level making sure the back of the bracket ('Load Bearing Zone') is in full contact with the support structure. Only IG shims can be used with IG's masonry support systems.

Correct and incorrect installation examples are provided in Figure 1.

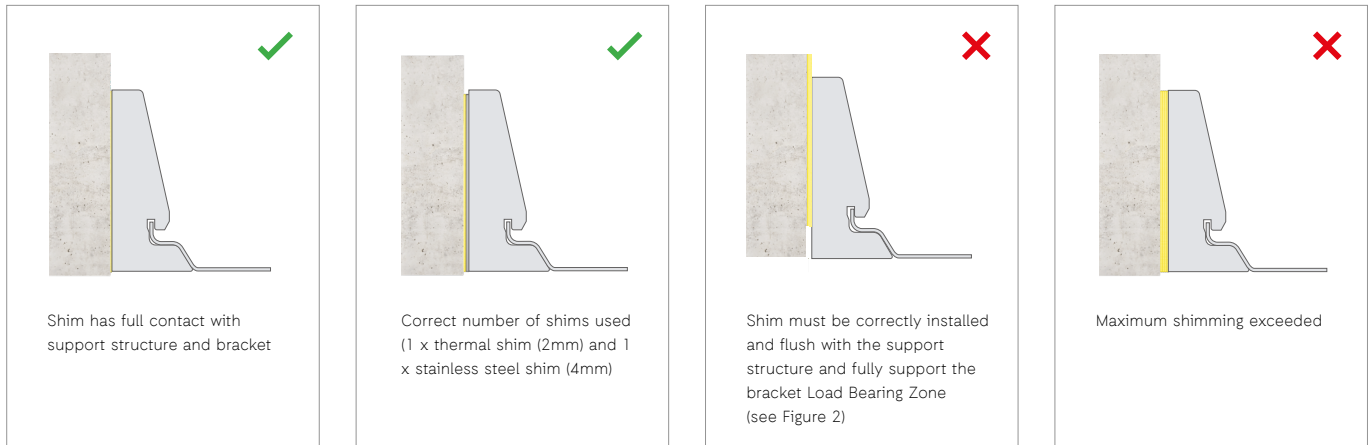

Figure 1



Brackets and shims must be installed at the correct level making sure the back of the bracket ('Load Bearing Zone') is in full contact with the support structure. Only IG shims can be used with IG masonry support systems.

### Installation guidance

The following guidelines should be adhered to when installing all IG Shims with IG's masonry support systems:

- The combined thickness of shims used per bracket should never exceed the outside diameter of the fixing or 12mm, whichever is less
- The collective number of shims that can be used should never exceed three
- Shims must support, and come into contact with the full 'Load Bearing Zone' (refer to Figure 2).

2mm Thermal Shims are provided as standard with IG's masonry support systems. Additional Stainless Steel Shims are available to purchase on request.

If your project exceeds the above shimming recommendations, contact our technical team.

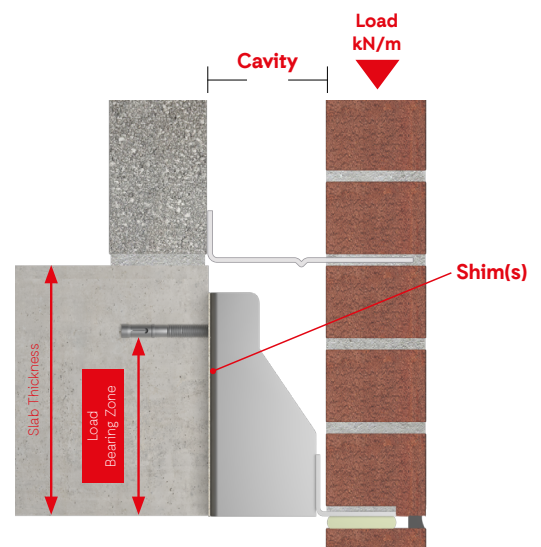

Figure 2

### Installation training

Correct installation is essential for the success of each project. Therefore, IG Masonry Support have made every effort to help installers by creating an [easy-to-use installation guides for each masonry support system](#).

IG Masonry Support also offers onsite installation training and support from its experienced team of structural and civil engineers.

### A1 non-combustible material

All IG Masonry Support's stainless steel shims are manufactured from 304/304L Austenitic Stainless Steel (1.4301/1.4307) or 316/316L (1.4401/1.4404) on request. Stainless steel is considered A1 fire-rated without the need for testing in accordance with the guidance of the European Commission Paper 96/603/EC as referenced in BS EN 13501-1:2018.

### Bi-metallic corrosion

Bi-metallic corrosion can occur when stainless steel and carbon steel are in direct contact with each other in a damp environment. This can be avoided by isolating the two metals. IG Masonry Support supply a Thermal Shim as standard, which must be located between the back of the bracket and support structure.

### Safety

While Stainless Steel Shims are easy to handle, the components are produced from stainless steel plates and may have sharp edges. Care must be taken when handling and suitable PPE should be worn at all times.

### Disposal

Stainless Steel Shims are fully recyclable, minimising waste and reducing its carbon footprint at the end of its service life.

### Specifying and ordering

IG Masonry Support's designers and engineers provide a full design service for each masonry support system on offer, tailored to the requirements of each project.

## Stainless Steel Shim Sales and Enquiries

For more information  
please contact our Technical Team

**+44 (0)1283 200 157**

**IG Masonry Support  
Swadlincote**

Ryder Close  
Cadley Hill Industrial Estate  
Swadlincote  
South Derbyshire  
DE11 9EU

T +44 (0)1283 200 157  
E [support@igmss.co.uk](mailto:support@igmss.co.uk)

**IG Masonry Support  
Cookstown**

Ballyreagh Industrial Estate  
Cookstown  
Co. Tyrone  
Northern Ireland  
BT80 9DG

T +44 (0)28 8676 0334  
E [info@igmss.co.uk](mailto:info@igmss.co.uk)